

## Swivel Fill Limit Valves for EPA Compliant Fuel Systems Perko Series 0586S0A for Aluminum Tanks

### INSTALLATION INSTRUCTIONS PLEASE READ ALL INSTRUCTIONS BEFORE PROCEEDING

These valves are for use on fuel tanks to comply with the CARB and EPA standards and meet the requirements of U.S.C.G. Safety Standards (July 31, 2011) for 40 CFR Parts 9, 60, 80 et al. (Control of Diurnal Emissions From Nonroad Spark-Ignition Engines and Equipment). **Note: Inspect valve fitting and snap ring annually for corrosion, replace if necessary.**

#### Series 0586S0A Fuel Limit Vent Valves (FLVV)

Note: The ullage depth is set by the tank manufacturer or OEM builder and cannot be changed. In order to maintain compliance with the EPA and CARB requirements, these valves that set the ullage depth cannot be interchanged with different depth valves.

1. These valves are designed to mount on aluminum surfaces.
2. Select your mounting location. Drill 1-3/4" diameter hole for valve receiver.
3. Weld the receiver to the tank
4. Slide the valve into receiver and orient hose barb in the direction of the vent line. Attach locking snap ring to hold valve in the receiver.
5. Attach 5/8" vent hose onto hose barb and tighten using hose clamps in accordance with ABYC Fuel System Vent Hose Clamping Standards (H24 Table 3).

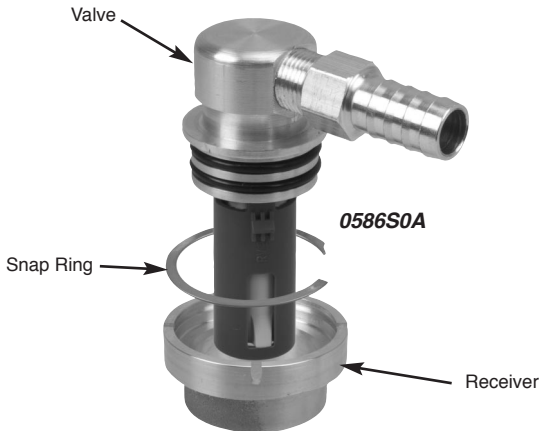

\*The above referenced standards can be obtained from:

- |   |   |  |
|---|---|--|
| (1). American Boat & Yacht Council, Inc.<br>613 Third Street, Suite 10<br>Annapolis, MD 21403 | (2) U.S. Coast Guard<br>Washington, D.C. 20593<br>(or your local C.G. office) | (3). E.P.A.<br>401 "M" Street S.W.<br>Washington, D.C. 20460 |
|---|---|--|